

6X Hall-Effect Systems

2Ø Stepper Motor Systems

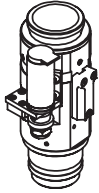

MOTORIZED ZOOM/NO F.F.
1-62605

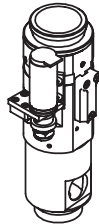

MOTORIZED ZOOM w/COAX PORT/NO F.F.
1-62608

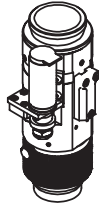

MOTORIZED ZOOM w/12 mm F.F.
1-62523

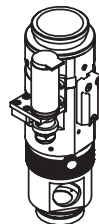

MOTORIZED ZOOM w/3 mm F.F. & COAX PORT
1-62525

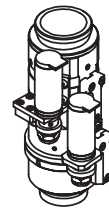

MOTORIZED ZOOM & 12 mm F.F.
1-62318

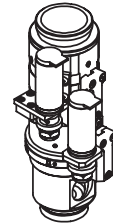

MOTORIZED ZOOM & 3 mm F.F. w/COAX PORT
1-62319

DC/Encoded Motor Systems

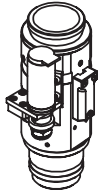

MOTORIZED ZOOM/NO F.F.
1-62606

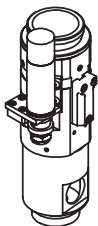

MOTORIZED ZOOM w/COAX PORT/NO F.F.
1-62609

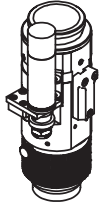

MOTORIZED ZOOM w/12 mm F.F.
1-62522

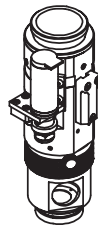

MOTORIZED ZOOM w/3 mm F.F. & COAX PORT
1-62524

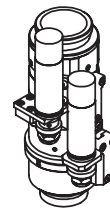

MOTORIZED ZOOM & 12 mm F.F.
1-62310

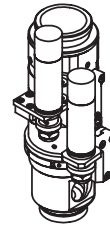

MOTORIZED ZOOM & 3 mm F.F. w/COAX PORT
1-62311

5Ø Stepper Motor Systems



MOTORIZED ZOOM/NO F.F.
1-62604



MOTORIZED ZOOM w/COAX PORT/NO F.F.
1-62607



MOTORIZED ZOOM w/12 mm F.F.
1-62521



MOTORIZED ZOOM w/3 mm F.F. & COAX PORT
1-62526

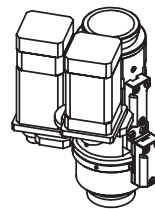

MOTORIZED ZOOM & 12 mm F.F.
1-62314

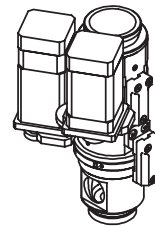

MOTORIZED ZOOM & 3 mm F.F. w/COAX PORT
1-62315